



### 32NT91-1



*Actual product appearance may vary.*

**NT Series Toggle Switch, 2 pole, 3 position, Quick Connect terminal, Standard Lever**

#### Features











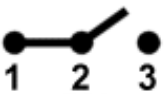

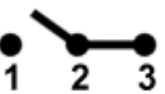



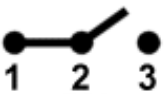

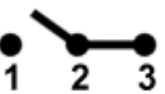
- Completely sealed switching chamber
- NEMA 3, 3R, 4, and 13
- UL recognized, File E12252, Vol. 1, Section 44
- CSA certified, File LR4442
- CE approved

#### Potential Applications

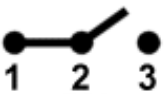
- Aerial lifts, scissor lifts, truck mounted tele-handlers, and cranes
- Construction equipment
- Agriculture equipment
- Material-handling equipment
- Factory-floor control units
- Machine tool equipment manufacturers

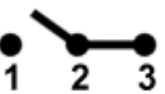
#### Description

MICRO SWITCH™ NT Series toggle switches meet the need for a rugged, cost-effective toggle switch. Quality construction features include a seal between the toggle lever and bushing, and between the cover and case. These switches can be used where panels are subject to splashes, hosedowns, or outdoor environments. The "Easy-Start" threaded bushing enables quick alignment of mounting nut to decrease the chance of cross threading. The panel stand-off with O-ring feature available on some listings, eliminates the need for behind-the-panel hardware, provides uniform panel height, and provides a panel to cover seal.

Product Specifications													
Circuitry/ Operating action	<table border="0"> <thead> <tr> <th>Keyway Position</th> <th>Center Position</th> <th>Opposite Keyway Position</th> </tr> </thead> <tbody> <tr> <td></td> <td></td> <td></td> </tr> <tr> <td></td> <td></td> <td></td> </tr> <tr> <td>ON</td> <td>OFF</td> <td>ON</td> </tr> </tbody> </table>	Keyway Position	Center Position	Opposite Keyway Position							ON	OFF	ON
Keyway Position	Center Position	Opposite Keyway Position											
													
													
ON	OFF	ON											
Product Type	MICRO SWITCH™ Toggle Switch												
Ampere/ Voltage Range (Resistive Load)	0.5 A to 15 A at 0.5 Vac to 277 Vac, 0.5 A to 20 A at 0.5 Vdc to 28 Vdc, 0.5 A at 250 Vdc, 0.75 A at 115 Vdc												
Circuitry	DPDT												
Action	3 position												
Mounting	Bushing 15/32 in												
Termination	Quick Connect												
Lever Type	Standard												
UL/CSA Rating Code	L191: 15 A-125, 250, 277 Vac; 1/2 Hp-125 Vac; 1 Hp-250, 277 Vac; 5 A-120 Vac "L"												
Comment	Switches are capable of withstanding a temperature of 160 degrees F continuously at full rated load												
Availability	Global												
UNSPSC Code	30211908												
UNSPSC Commodity	30211908 Toggle switches												
Series Name	NT												

CATALOG LISTING  
**32NT91 SERIES CHART 1**

PAGE 1 OF 1

ISSUE 7

REPLACES -

REVISIONS

A	C095305	TSM	9NOV99
B	CO-94361	DCS	23 NOV 99
C	207782	C S L	27 MAR 03
D	0002084	C S L	18 NOV 03
E	0002302	C S L	10 DEC 03

9NOV99

SAV

CHECK

9NOV99

PTC/CAD 2D  
DRAWN

.076±.008 WIDE KEYWAY

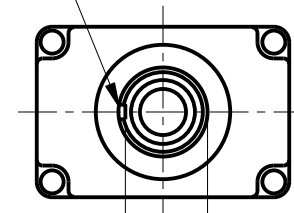

.427

17°±4°  
34°±8° TOTAL TRAVEL

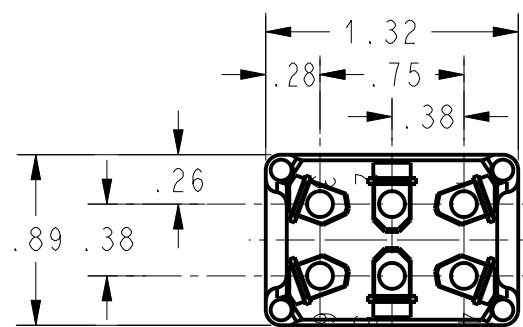
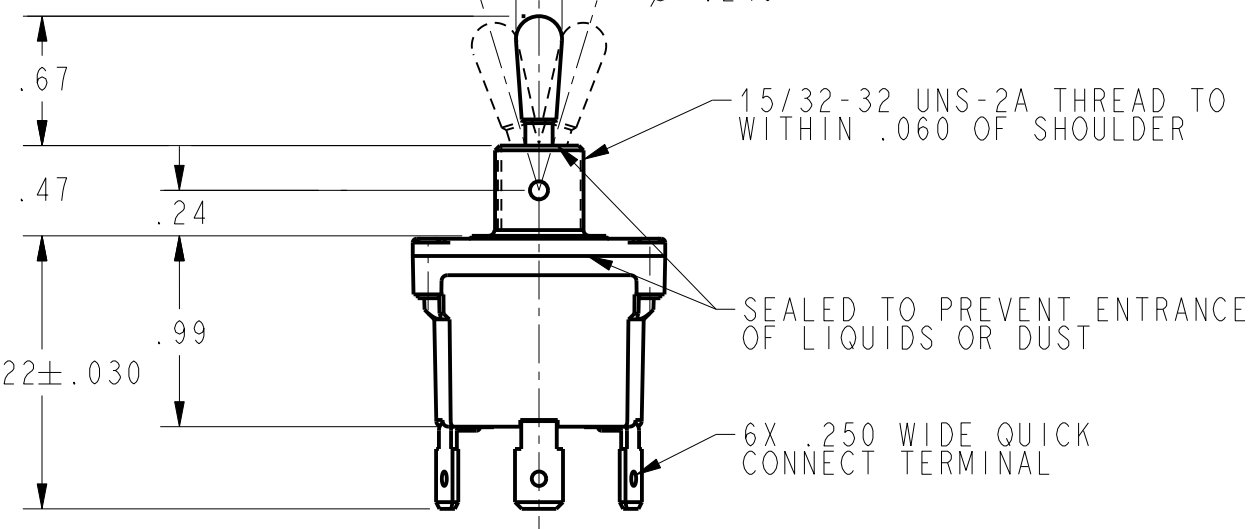

CATALOG LISTING	CIRCUIT MADE WITH TOGGLE LEVER IN $\triangle 4$			ELECTRICAL DATA
	KEYWAY SIDE (1-2, 4-5)	CENTER (1-2, 4-5)	OPPOSITE KEYWAY (2-3, 5-6)	
32NT91-1	ON	OFF	ON	L191 15A 125, <u>250</u> , 277 VAC 1/2HP 125 VAC 1HP <u>250</u> , 277 VAC 5A 125 VAC "L"
32NT91-2	OFF	NONE	ON	
32NT91-3	ON	NONE	ON	
32NT91-21	NONE	OFF	ON	
32NT91-31	NONE	ON	ON	
32NT91-4	MOM OFF	NONE	ON	
32NT91-5	MOM ON	OFF	ON	
32NT91-6	MOM ON	NONE	OFF	
32NT91-7	MOM ON	OFF	MOM ON	L192 10A 125, <u>250</u> , 277 VAC 1/4HP 125 VAC 1/2HP <u>250</u> , 277 VAC 3A 125 VAC "L"
32NT91-8	MOM ON	NONE	ON	
$\triangle A$	NONE	ON	MOM ON	
32NT91-61	MOM ON	OFF	NONE	

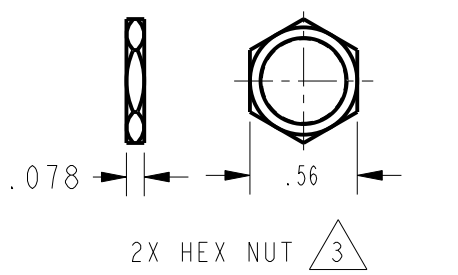
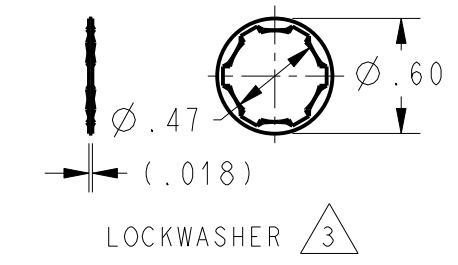
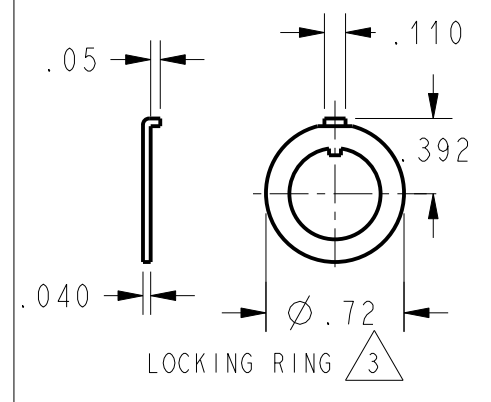

- NOTES
- 1 - SWITCHES ARE CAPABLE OF WITHSTANDING A TEMPERATURE OF 160°F CONTINUOUSLY AT FULL RATED LOAD
  - 2 - MICRO SWITCH CAT. LIST. MARKED ON SIDE OF SWITCH
  - $\triangle 3$  FURNISHED UNASSEMBLED
  - $\triangle 4$  APPLIES ONLY TO "ON" AND "MOMENTARY ON" POSITIONS
  - 5 - TO ORDER WITHOUT HARDWARE ADD (-NH) SUFFIX TO CATALOG LISTING

THIRD ANGLE PROJECTION	
SCALE	FULL
DO NOT SCALE PRINT	
UNLESS OTHERWISE SPECIFIED TOLERANCES ARE	
ONE PLACE	(.0) ±.030
TWO PLACE	(.00) ±.015
THREE PLACE	(.000) ±.005
ANGLES	±
WEIGHT	